

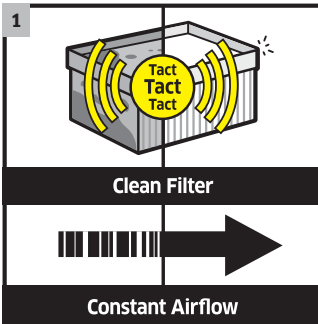

## IVC 60/24-2 Tact²

Geniş tekerlekli ve fren sistemi olan kompakt endüstriyel elektrik süpürGESİDİR. TACT otomatik filtre temizleme sistemi sayesinde kesintisiz uzun süreli kullanımlara uygundur.



### 1 Otomatik Tact² filtre temizleme sistemi

- Filtre kendini güçlü hava darbeleriyle temizler. Bu otomatik proses yüksek ve sürekli emiş gücü sağlar. Ayrıca daha düşük bakım maliyetleri ve uzun filtre kullanım ömrünü beraberinde getirir
- Sabit yüksek emiş gücü ile kesintisiz kullanım için tasarlanmış filtre.

### 2 İki üfleme motoru

- Güçlü temizlik işlemi için iki üfleme motoru. Motorlar elektronik olarak kontrol edilir, böylece yüksek çalışmaya başlama akımlarının önüne geçilir.



### 3 Çökertme mekanizmasına sahip atık konteyneri

- Çökertme mekanizmalı atık konteyneri, çekilen atıklar ağır olduğu zaman ergonomik bir şekilde boşaltmaya olanak sağlar.



### 4 Düz oluklu kompakt filtrelili

- Kompakt düz oluklu filtre, küçük ve açık bir tasarımla daha geniş bir filtreleme alanı sağlar.



IVC 60/24-2 Tact²

■ Antistatik ekipman

### Teknik veriler

<b>Sipariş No.</b>	1.576-100.0	
<b>EAN Kodu</b>	4039784463691	
<b>Mevcut tip</b>	<b>Ph / V / Hz</b>	1 / 220 - 240 / 50 - 60
<b>Hava debisi</b>	<b>l/s / m³/saat</b>	148 / 532
<b>Vakum gücü</b>	<b>mbar / kPa</b>	254 / 25,4
<b>Konteyner kapasitesi</b>	<b>l</b>	60
<b>Motor değerleri</b>	<b>kW</b>	2,4
<b>Filtre alanı</b>	<b>m²</b>	0,95
<b>Bağlantı çapı</b>	Çap 70	
<b>Standard aksesuar çapı</b>	Çap 50 / Çap 40	
<b>Ses seviyesi</b>	<b>dB(A)</b>	73
<b>Boyutlar (U x G x Y)</b>	<b>mm</b>	970 x 690 x 995

### Ekipman

<b>Makineye dahil aksesuarlar</b>	hayır
-----------------------------------	-------

# IVC 60/24-2 TACT<sup>2</sup> 1.576-100.0

**KÄRCHER**

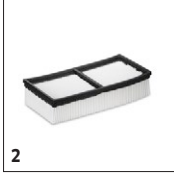

		Sipariş No.	Anzahl	Dummy	Dummy	Dummy	Fiyat	Tanımlama	
<b>Düz pleli ffiltr (Kağıt)</b>									
Yassı kıvrılmış filtre, kağıt	1	6.907-276.0	1 Adet						<input type="checkbox"/>
<b>Düz pileli filtre (PTFE)</b>									
Flat-pleated filter packaged PTFE	2	6.907-449.0	1 Adet						<input type="checkbox"/>

Mevcut aksesuarlar

# IVC 60/24-2 TACT<sup>2</sup> 1.576-100.0

KÄRCHER



		Sipariş No.	Miktar		uzun- luk/ Genişlik	Fiyat	Tanımlama	
<b>Adaptör Aksesuarı</b>								
Adapter DN50/DN51	1	9.989-603.0		DN 50				<input type="checkbox"/>
Adapter DN51/DN50	2	9.989-601.0		DN 50				<input type="checkbox"/>
Adapter DN50/DN61	3	9.989-602.0		DN 50				<input type="checkbox"/>
Adapter DN61/DN50	4	9.989-604.0		DN 50				<input type="checkbox"/>
<b>Redüktörler</b>								
Reducer DN 70/DN 50 (SBC)	5	9.977-772.0		DN 70				<input type="checkbox"/>
Reducer DN70/DN40	6	9.989-690.0		DN 70				<input type="checkbox"/>
	7	9.981-231.0		DN 50				<input type="checkbox"/>
Reducer V2A DN72 auf DN52	8	9.989-712.0		DN 70				<input type="checkbox"/>
Reducer V2A DN70/DN40	9	9.989-713.0		DN 70				<input type="checkbox"/>
<b>Geniştiriciler</b>								
	10	9.981-921.0		DN 50				<input type="checkbox"/>
<b>Distribütörler</b>								
Distribütör DN70/DN50/DN50	11	9.989-611.0		DN 70				<input type="checkbox"/>
<b>PVC</b>								
Hose PVC DN40 3 m	12	9.989-647.0		DN 40				<input type="checkbox"/>
Hose PVC DN40 5 m	13	9.989-614.0		DN 40				<input type="checkbox"/>
Hose without connection PVC DN40 15 m	14	9.989-633.0		DN 40				<input type="checkbox"/>
Hose PVC DN50 3 m	15	9.989-615.0		DN 50				<input type="checkbox"/>
Hose PVC DN50 5 m	16	9.989-616.0		DN 50				<input type="checkbox"/>
Hose without connection PVC DN50 15 m	17	9.989-634.0		DN 50				<input type="checkbox"/>
Hose PVC DN40 1 m	18	9.989-626.0		DN 40				<input type="checkbox"/>
<b>EVA</b>								
Extension hose EVA el. DN42 3m	19	9.988-088.0		DN 40				<input type="checkbox"/>
Extension hose EVA el. DN42 5m	20	9.988-089.0		DN 40				<input type="checkbox"/>
Hose without connection EVA DN40 15 m	21	9.989-630.0		DN 40				<input type="checkbox"/>
Extension hose EVA el. DN52 3m	22	9.988-090.0		DN 50				<input type="checkbox"/>
Extension hose EVA el. DN52 5m	23	9.988-091.0		DN 50				<input type="checkbox"/>
Hose without connection EVA DN50 15 m	24	9.989-631.0		DN 50				<input type="checkbox"/>
<b>ME</b>								
Hose connection kit DN40	25	9.989-627.0		DN 40				<input type="checkbox"/>
Hose connection kit DN50	26	9.989-628.0		DN 50				<input type="checkbox"/>
<b>PU</b>								
Hose PU DN40 3 m	27	9.989-617.0		DN 40				<input type="checkbox"/>
Hose PU DN40 5 m	28	9.989-618.0		DN 40				<input type="checkbox"/>
Hose without connection PU DN40 15 m	29	9.989-637.0		DN 40				<input type="checkbox"/>
Hose PU DN50 3 m	30	9.989-619.0		DN 50				<input type="checkbox"/>
Hose PU DN50 5 m	31	9.989-620.0		DN 50				<input type="checkbox"/>
Hose without connection PU DN50 15 m	32	9.989-638.0		DN 50				<input type="checkbox"/>

Mevcut aksesuarlar

# IVC 60/24-2 TACT<sup>2</sup> 1.576-100.0

KÄRCHER



		Sipariş No.	Miktar		uzun- luk/ Genişlik	Fiyat	Tanımlama	
<b>ME-PU</b>								
Hose ME-PU DN40 3 m	33	9.989-621.0		DN 40				<input type="checkbox"/>
	34	9.989-622.0		DN 40				<input type="checkbox"/>
Hose without connection ME-PU DN40 15 m	35	9.989-640.0		DN 40				<input type="checkbox"/>
Hose ME-PU DN50 3 m	36	9.989-623.0		DN 50				<input type="checkbox"/>
Hose ME-PU DN50 5 m	37	9.989-625.0		DN 50				<input type="checkbox"/>
Hose without connection ME-PU DN50 15 m	38	9.989-641.0		DN 50				<input type="checkbox"/>
<b>Kolları</b>								
Hand grip curved 45°, DN 42	39	9.977-679.0		DN 40				<input type="checkbox"/>
Hand grip 45°, DN 52 ohne Sterngriff	40	9.977-678.0		DN 50				<input type="checkbox"/>
Hand grip curved stainless steel 45°IK D	41	9.989-036.0		DN 40				<input type="checkbox"/>
Hand grip curved stainless steel 45°, IK	42	9.988-111.0		DN 50				<input type="checkbox"/>
Elbow aluminium 45° DN40	43	9.989-544.0						<input type="checkbox"/>
Elbow aluminium 45° DN50	44	9.989-547.0						<input type="checkbox"/>
<b>Emiş boruları</b>								
Suction tube 750 mm DN40	45	9.977-525.0		DN 40				<input type="checkbox"/>
Extension pipe 850mm DN 50, SBG	46	9.977-531.0		DN 50				<input type="checkbox"/>
Extension pipe stainless steel DN50 US	47	9.989-038.0		DN 40				<input type="checkbox"/>
Hand grip curved stainless steel 45°IK D	48	9.989-035.0		DN 50				<input type="checkbox"/>
Extension pipe stainless steel DN40 US	49	9.989-039.0		DN 40				<input type="checkbox"/>
Extension pipe stainless steel DN50 IK,	50	9.988-114.0		DN 50				<input type="checkbox"/>
Suction tube carbon 1500mm DN40	51	9.989-552.0		DN 40				<input type="checkbox"/>
Suction tube carbon 1500mm DN50	52	9.989-553.0		DN 50				<input type="checkbox"/>
<b>Standart nozullar</b>								
Standard nozzle PVC DN40	53	9.989-674.0		DN 40				<input type="checkbox"/>
Standard nozzle PVC DN50	54	9.989-673.0		DN 50				<input type="checkbox"/>
Nozzle elastic silicon DN42	55	9.988-401.0		DN 40				<input type="checkbox"/>
Nozzle elastic silicon DN52	56	9.988-402.0		DN 50				<input type="checkbox"/>
Standard nozzle rubber cuttable DN40	57	9.989-677.0		DN 40				<input type="checkbox"/>
Standard nozzle rubber cuttable DN50	58	9.989-675.0		DN 50				<input type="checkbox"/>
	59	9.980-748.0		DN 40				<input type="checkbox"/>
	60	9.980-749.0		DN 50				<input type="checkbox"/>

Mevcut aksesuarlar



# IVC 60/24-2 TACT<sup>2</sup> 1.576-100.0

KÄRCHER



		Sipariş No.	Miktar		uzun- luk/ Genişlik	Fiyat	Tanımlama	
<b>Bükülebilir standart nozullar</b>								
Nozzle flexible rubber mouthpiece DN40/D	61	9.981-420.0		DN 40				<input type="checkbox"/>
Nozul, çinko kaplamalı, esnek, kauçuk uçlu	62	9.981-421.0		DN 50				<input type="checkbox"/>
	63	9.981-429.0		DN 40				<input type="checkbox"/>
	64	9.981-430.0		DN 50				<input type="checkbox"/>
<b>Zemin nozulları</b>								
Floor nozzle Alu 370 mm DN40	65	9.989-683.0		DN 40				<input type="checkbox"/>
Floor nozzle Alu el 370 mm DN40	66	9.989-682.0		DN 40				<input type="checkbox"/>
	67	9.981-426.0		DN 50				<input type="checkbox"/>
Floor nozzle Alu 370 mm DN50	68	9.989-664.0		DN 50				<input type="checkbox"/>
Multi-purpose nozzle 370mm el. leit., DN	69	9.987-612.0		DN 50				<input type="checkbox"/>
Floor nozzle Alu 500 mm DN50	70	9.989-684.0		DN 50				<input type="checkbox"/>
	71	9.981-925.0		DN 50				<input type="checkbox"/>
Multi-purpose nozzle 370mm el. leit., DN	72	9.989-558.0		DN 40				<input type="checkbox"/>
	73	9.988-115.0		DN 50				<input type="checkbox"/>
	74	9.981-923.0						<input type="checkbox"/>
Rubber lips with molding 370mm	75	9.981-914.0						<input type="checkbox"/>
	76	9.981-915.0						<input type="checkbox"/>
Bürstenleiste Satz elektr. leitend, für	77	9.984-939.0						<input type="checkbox"/>
	78	9.980-764.0						<input type="checkbox"/>
<b>Aralık temizleme nozulları</b>								
Slot nozzle flat DN50	79	9.988-117.0		DN 50				<input type="checkbox"/>
	80	9.981-482.0		DN 50				<input type="checkbox"/>
	81	9.981-442.0		DN 50				<input type="checkbox"/>
	82	9.981-465.0		DN 50				<input type="checkbox"/>
<b>Esnek aralık nozulları</b>								
Nozzle Langschaft Silikon DN52	83	9.988-403.0		DN 50				<input type="checkbox"/>
Nozzle Crevice nozzle bendable 11 mm x 5	84	9.989-681.0		DN 40				<input type="checkbox"/>
Slot nozzle flexible DN 40	85	9.981-423.0		DN 40				<input type="checkbox"/>
	86	9.981-424.0		DN 50				<input type="checkbox"/>
Slot nozzle flexible DN 50, 20mm	87	9.981-425.0		DN 50				<input type="checkbox"/>
<b>Yüzey memeleri</b>								
Nozzle with connecting piece 90° DN40	88	9.988-118.0		DN 40				<input type="checkbox"/>
Nozzle with connecting piece 90° DN50	89	9.988-119.0		DN 50				<input type="checkbox"/>
Nozzle Surface nozzle Alu 150 mm DN40	90	9.989-666.0		DN 40				<input type="checkbox"/>
Nozzle Surface nozzle Alu 150 mm DN50	91	9.989-665.0		DN 50				<input type="checkbox"/>
<b>Likit nozüller</b>								
	92	9.981-427.0		DN 50				<input type="checkbox"/>

Mevcut aksesuarlar

# IVC 60/24-2 TACT<sup>2</sup> 1.576-100.0

KÄRCHER



		Sipariş No.	Miktar	uzun- luk/ Genişlik	Fiyat	Tanımlama	
<b>Kör delik nozulları</b>							
Nozzle Blind hole nozzle DN40	93	9.989-671.0		DN 40			<input type="checkbox"/>
Nozzle Blind hole nozzle bended 60° DN40	94	9.989-669.0		DN 40			<input type="checkbox"/>
Nozzle Blind hole nozzle bended 90° DN40	95	9.989-667.0		DN 40			<input type="checkbox"/>
Nozzle Blind hole nozzle bended 90° 200	96	9.989-670.0		DN 40			<input type="checkbox"/>
<b>Standard fırçalar</b>							
	97	9.981-431.0		DN 40			<input type="checkbox"/>
	98	9.981-432.0		DN 50			<input type="checkbox"/>
<b>Kalem fırçalar</b>							
Brush ø82 mm DN40	99	9.989-609.0		DN 40			<input type="checkbox"/>
Brush ø82 mm DN50	100	9.989-608.0		DN 50			<input type="checkbox"/>
<b>Yüzey fırçaları</b>							
Brush PP 24 mm DN40	101	9.989-610.0		DN 40			<input type="checkbox"/>
Süpürge fırçası	102	9.981-911.0		DN 40			<input type="checkbox"/>
	103	9.981-912.0		DN 50			<input type="checkbox"/>
<b>Ön ayırıcı</b>							
Separator Tc Op Liquid 125 l DN70	104	9.989-686.0		DN 70			<input type="checkbox"/>
<b>Sivılar</b>							
Kit liquid DN40	105	9.989-660.0		DN 40			<input type="checkbox"/>
Kit liquid DN50	106	9.989-661.0		DN 50			<input type="checkbox"/>
<b>Sivılar / talaş</b>							
Kit liquid swarf 3 m DN40	107	9.989-657.0		DN 40			<input type="checkbox"/>
Kit liquid swarf DN50	108	9.989-658.0		DN 50			<input type="checkbox"/>

Mevcut aksesuarlar